

T18000001221

(Requestor's Name)

(Address)

(Address)

(City/State/Zip/Phone #)

PICK-UP WAIT MAIL

(Business Entity Name)

(Document Number)

Certified Copies _____ Certificates of Status _____

Special Instructions to Filing Officer:

Office Use Only

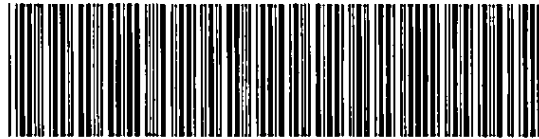

700321079417

T18-1221

11/27/18--01010--001 **87.50 ✓

NOV 27 PM 12:41

N. CAUSSEAU
NOV 28 2018

APPLICATION FOR THE REGISTRATION OF A TRADEMARK OR SERVICE MARK
PURSUANT TO CHAPTER 495, FLORIDA STATUTES

RECEIVED
1988 NOV 27 PM 12:41

TO: Division of Corporations
Post Office Box 6327
Tallahassee, FL 32314

PART I

1. OWNER/APPLICANT: Enter the name and address of the individual or the business entity to be listed as the owner of the Trademark and/or Service Mark on the records of the Florida Department of State.

(a) Owner's/Applicant's name: The Allen Morris Company
121 Alhambra Plaza, Suite 1600
(b) Owner's/Applicant's business address: Coral Gables, FL 33134
City/State/Zip

If different, Owner's/Applicant's mailing address: _____
City/State/Zip

(c) Owner's/Applicant's telephone number: 305 476-2546

Check the appropriate box to indicate the Owner/Applicant is a(n):

- Individual Corporation Joint Venture Limited Liability Company
 General Partnership Limited Partnership Union Other: _____

If the Owner/Applicant is a business entity, the business entity must have an active filing or registration on file with the Florida Department of State. If the Owner/Applicant is not an individual, enter the business entity's Florida registration/document number in #1, the state or country under the laws of which the business entity is currently formed, organized or incorporated under in #2, and the entity's federal employer identification number (EIN) in #3.

- (1) Florida registration/document number: 210633 ✓
(2) Domicile State or Country: Florida
(3) Federal Employer Identification Number: 59-0824139

2. (a) SERVICE MARK: If the owner/applicant is using the name, logo, design and/or slogan being registered in connection with a type of service, the mark is a service mark. If the mark is a service mark, the applicant/owner must list the specific service(s) the mark is being used in connection with. For example: furniture moving services, diaper services, house painting services, wholesale and retail sales of tractor equipment, etc. If the owner/applicant is using the mark to identify services available in the market place, enter the specific service(s) being rendered here:

(Note: List only those services currently being rendered by the owner/applicant. Do not include future services.)

Real Property, leasing of office space

2. (b) TRADEMARK: If the owner/applicant is using the name, logo, design and/or slogan being registered in connection with an actual product manufactured by the owner/applicant or on the owner/applicant's behalf, the mark is a trademark. If the mark is a trademark, the applicant/owner must list the specific product(s) the name, logo, design and/or slogan is being used to identify. For example: ladies sportswear, cat food, barbecue grills, shoe laces, etc. If the owner/applicant is using the name, logo, design and/or slogan to identify goods available in the market place, enter the specific product(s) the name, logo, design and/or slogan is being used to identify:

(Note: List only those product(s) currently available. Do not include future products.)

2. (c) HOW IS THE NAME, LOGO, DESIGN AND/OR SLOGAN CURRENTLY USED:

SERVICE MARKS: If the name, logo, design and/or slogan are/is being used in connection with a type of service, you must specify the form(s)/mean(s) of advertisement the applicant/owner is using to advertise the services to the general public. For example: newspaper advertisements, business cards, brochures, flyers, pamphlets, menus, etc. If the mark is being used in connection with a type of service, state how the name, logo, design and/or slogan are/is being used in advertising here:

Advertising, brochures and sales materials.

TRADEMARKS: If the name, logo, design and/or slogan are/is being used to identify a product manufactured by or fore the applicant/owner, you must specify how the mark is applied or affixed to the actual product or its packaging. For example: a tag, label, imprinted or engraved on the actual product, etc. If the mark is being used in connection with a specific product, state how the name, logo, design and/or slogan is applied or affixed to the actual product(s) or the packaging:

2. (d) FEE(S) AND CLASS(ES): There are a total of 45 classes or categories in which all products or services must be categorized. The fee to register a mark is \$87.50 per class. Make check payable to Florida Department of State.

List the class(es) which apply to the product(s) and/or service(s) listed in 2(a) and/or 2(b) above:

36

PART II

1. You must state the date the name, logo, design and/or slogan was first used in the state of Florida, and, if it was used in another state or country, the date you first used the name, logo, design and/or slogan in the other state or country. Enter the month, day, and year the name, logo, design and/or slogan was first used by the applicant/owner, the predecessor, or a related company in Florida. If the name, logo, design and/or slogan has been used in another state or country, then you must also enter the month, day, and year the name, logo, design and/or slogan was/were used in another state or country, when applicable.

Note: The Florida Statutes require a mark to be in use prior to registration.

(a) Date first used in other state or country, if applicable: _____

(b) Date first used in Florida: June 22, 1998

PART III

ENTER NAME, LOGO, DESIGN AND/OR SLOGAN BEING REGISTERED:

1. Enter the name, a brief description of the logo or design, and/or the slogan you are registering. The description of the logo and/or design must be 25 words or less. List the exact name, slogan, and/or description of the logo/design here: (NOTE: The name, logo, design and/or slogan listed in this section must match the exact name, logo, design and/or slogan listed on your specimens or examples.)

121 ALHAMBRA TOWERS & DESIGN OF GOLD & BLUE TOWER BUILDING WITH BLUE OVAL
DESIGN CONTAINING BLUE HORIZONTAL LINES & THE NUMBERS 121 WITHIN OVAL

Provide the English translation of any and all terms listed #1 above, when applicable: _____

2. **DISCLAIMER STATEMENT** (if applicable):

Your mark may include a word or design that is commonly used by others. Commonly used terms or designs must be disclaimed. When you disclaim a specific term or design, you are acknowledging this term is commonly used by others and that you do not claim the exclusive right to use the disclaimed term or design. All geographical terms and representations of cities, states or countries must be disclaimed (i.e., Miami, Orlando, Florida, the design of the state of Florida, the design of the United States of America, etc.). Corporate suffixes and terms readily associated with the specific product(s) and/or(s) service being provided must also be disclaimed.

Enter all terms listed in #1 above which require a disclaimer in the space provided below:

NO CLAIM IS MADE TO THE EXCLUSIVE RIGHT TO USE THE TERM(S) "Alhambra Towers"

_____ "APART FROM THE MARK AS SHOWN."

3. ATTACH OR INCLUDE THREE SPECIMENS OR EXAMPLES OF THE TRADEMARK OR SERVICE MARK BEING REGISTERED

Chapter 495, F.S., requires you to submit three specimens (samples or examples) of the mark in use. You must submit three specimens FOR EACH CLASS listed in Part I #2(d). The name, logo, design and/or slogan on the specimens must be identical to the name, logo, design and/or slogan being registered. You may provide three identical specimens or three different specimens. For each service mark class (classes 35-45), you may provide three newspaper advertisements, business cards, brochures, flyers, or any combination thereof. For each trademark class (classes 1-34), you may provide three tags, labels, boxes, etc. or any combination thereof. Photographs of bulky specimens are acceptable if the mark being registered and the good(s) or product(s) are clearly legible.

SIGNATURE OF APPLICANT/OWNER AND NOTARIZATION:

I, Yazmin Gil, being sworn, depose and say that I am the owner and the applicant herein, or that I am authorized to sign on behalf of the owner and applicant herein, and to the best of my knowledge no other person except a related company has registered this mark in this state or has the right to use such mark in Florida either in the identical form thereof or in such near resemblance as to be likely, when applied to the goods or services of such other person to cause confusion, to cause mistake or to deceive. I make this affidavit and verification on my/the applicant's behalf. I further acknowledge that I have read the application and know the contents thereof and that the facts stated herein are true and correct.

The Allen Morris Company

Typed or printed name of applicant

[Handwritten Signature]
Applicant's signature
(List name and title) Yazmin Gil

STATE OF Florida

COUNTY OF Miami- Dade

Sworn to and subscribed before me on this 14 day of November, 2016 [Handwritten Signature]
(Name of Individual Signing)

who is personally known to me whose identity I proved on the basis of _____

[Handwritten Signature]
Notary Public Signature
Maria L. Chapdelaine
Notary's Printed Name

(Seal)

My Commission Expires: _____

FILING FEE: \$87.50 per class

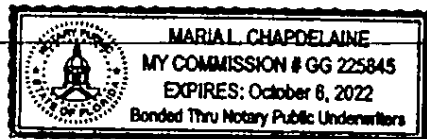

FILED
SECRETARY
STATE OF FLORIDA
NOV 27 12:41 PM '16

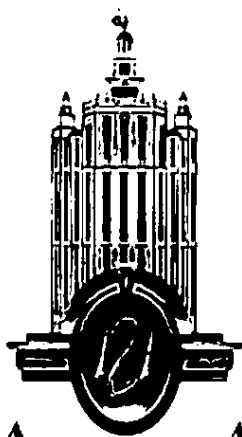

ALHAMBRA TOWERS

121 Alhambra Plaza
Coral Gables, FL 33134

An Award Winning
LANDMARK
Business Address

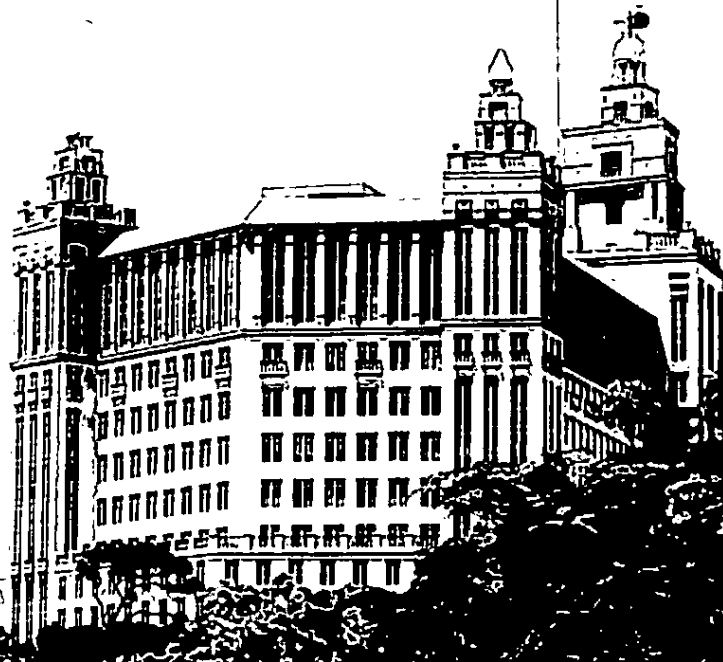

CLASS "A" FULL FLOOR FOR LEASE



22,603 Rentable Square Feet

Space offers:

- Forty-four perimeter windowed offices and conference rooms, all with extremely high-end finishes.
- Four executive office suites, each complete with personal bathrooms and all located in multi-cornered windowed spaces.
- White marble elevator lobby flooring.
- Extensive interior glass walls allowing for abundant natural light, even in the interior components of the space.
- Fully wired board and conference rooms.
- Break room with full kitchen appliances and a second smaller kitchen break room.

AM ALLENMORRIS
inspiring spaces to live and work

www.AlhambraTowers.com

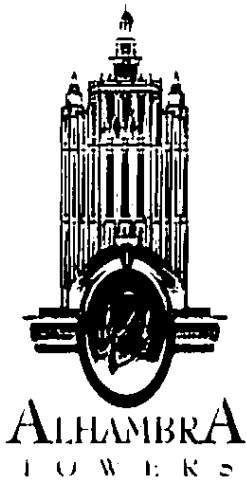
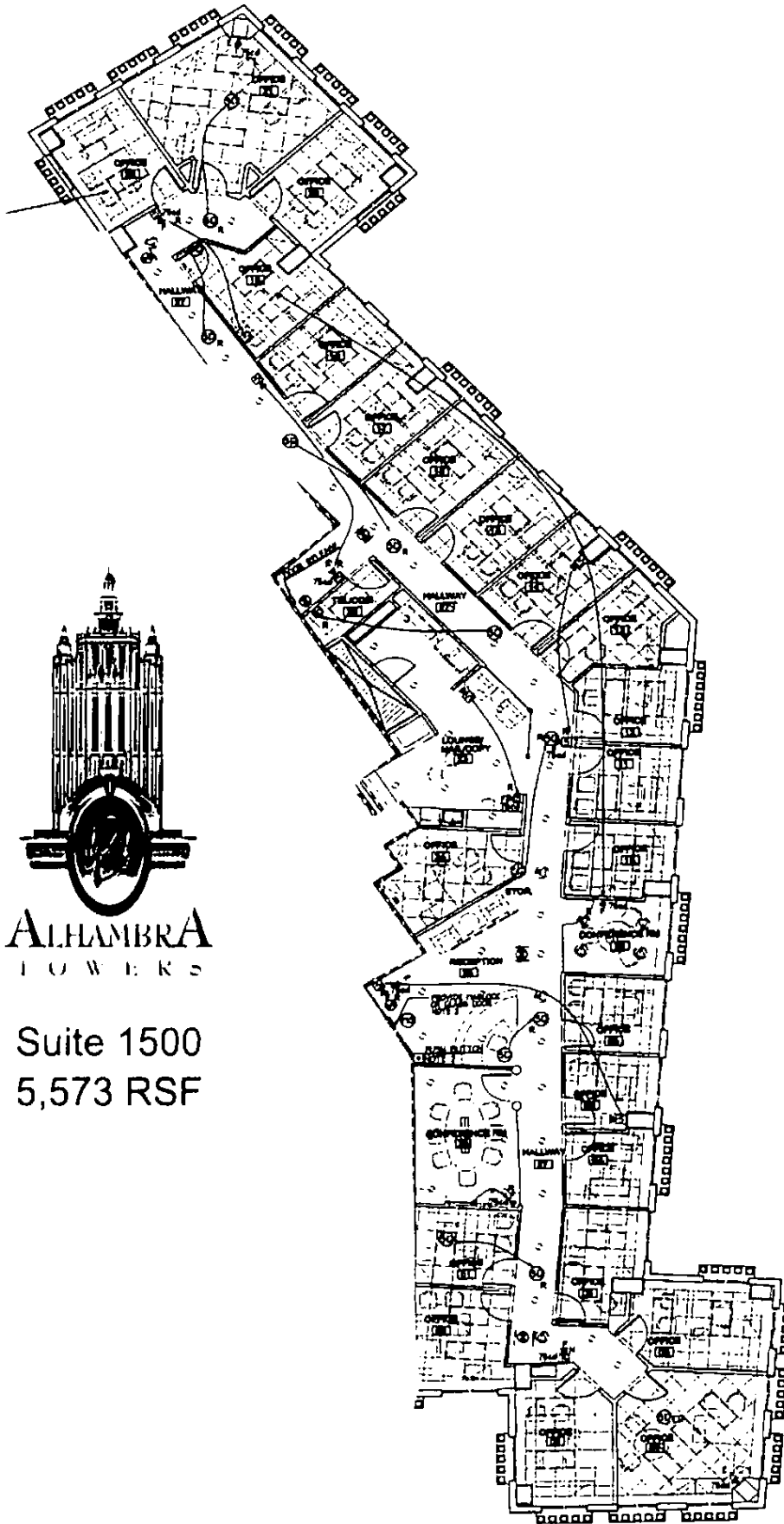

ALHAMBRA
TOWERS

Suite 1500
5,573 RSF

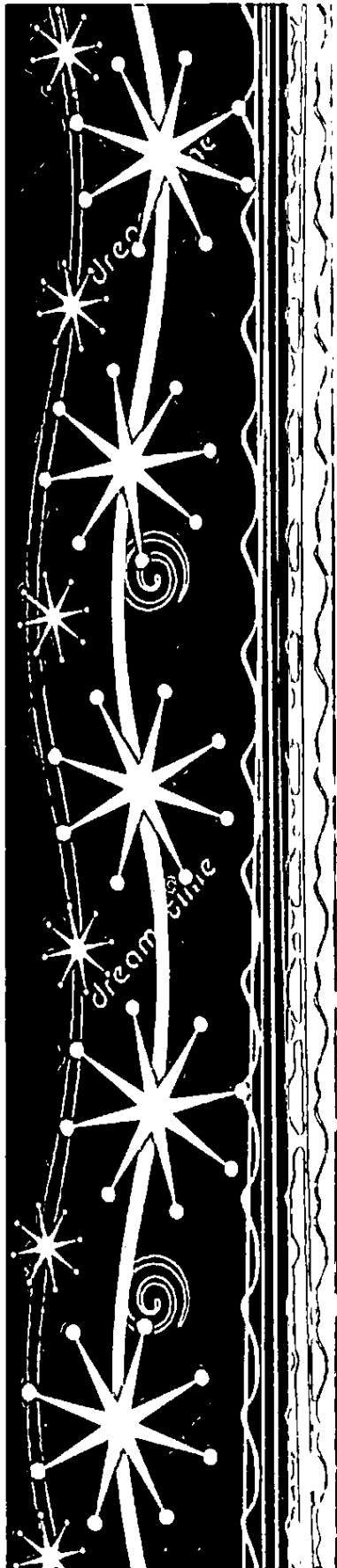

The Allen Morris Company

invites all tenants of
Alhambra Towers
to join in spreading good cheer at a

CHRISTMAS BREAKFAST

Wednesday, December 13, 2017

8:00 a.m. to 10:00 a.m.

Lobby Area

